



68th OPHA Annual Conference & Meeting

October 8-9, 2012
Corvallis OR



Oregon Public
Health Association



THE OHSU effect

Donn Spight, M.D., director of the OHSU VirtuOHSU Program, shares his knowledge with MedStars students who were visiting OHSU from around the state. MedStars, a collaboration between OHSU and Area Health Education Centers, encourages youths interested in careers in health and science to further their education in those fields.

Along with our community partners, OHSU health care providers, teachers and researchers:

- Provide care to the underserved.
- Deliver education that extends the reach of health care.
- Engage in research that is vital to public and community health.
- Ensure access to the latest in medical advances.

OHSU relies on its associations with individuals and organizations around the region. The connections we share allow us all to achieve together what none of us could do alone.

That's the OHSU Effect.

www.OHSUeffect.org
www.ohsu.edu/community





OPHA 68th Annual Meeting and Conference 2012 Agenda

MONDAY, OCTOBER 8, 2012

- 8:00 - 9:00** **Registration and Continental Breakfast** Gallery/Lobby (LaSells Stewart)
- 9:00 - 9:30** **Welcome and Opening Remarks** Austin Auditorium (LaSells Stewart)
- Chris Kabel, MPH
President - Oregon Public Health Association
- Tammy Bray, PhD
Dean, College of Public Health and Human Sciences
Oregon State University
- Julie Manning
Mayor, Corvallis
- 9:30 - 10:30** **Keynote Address** Austin Auditorium (LaSells Stewart)
- Richard J. Jackson, MD, MPH
Professor and Chair, Environmental Health Sciences
UCLA School of Public Health
- Introduction:
Philip Wu, MD
Kaiser Permanente
- 10:30 - 10:45** **BREAK** Gallery/Lobby (LaSells Stewart)
- 10:45 - 12:00** **Concurrent Sessions #1**
- (A) **PANEL:** Room 115 (Alumni Center)
- Reducing Health Disparities through Regional Equity Coalitions in Oregon**
Moderator/Discussant: Rachel Gilmer
Karen Levy Keon, Erin Tofte, Rocio Munoz, Carol Cheney, Brett Hamilton
- (B) **PANEL:** Construction/Eng. Aud. (LaSells Stewart)
- University of Oregon and Oregon State University: Creating a Healthier Campus and a Cleaner Environment**
Moderator/Discussant: Alexa Shook
Marci Torres, Paula Staight, Lisa Hoogesteger, Stacey Edwards

- (C) **BUILT ENVIRONMENT & OBESITY** Cascade Ballroom 110B (Alumni Center)
Moderator/Discussant: Chris Kabel
1. **The Influence of the Built Environment on Obesity in Oregon**
Daniel S. Morris
 2. **Changing the Context: What to do When the Built Environment has Put Healthy Eating and Active Living Out of Reach**
Beth Kaye, Daniel Morris
 3. **Brownfields and Public Health: The Story of Cully Park**
Kari Christensen, Rebecca Wells-Albers, Tony DeFalco, Jamie Hogue
- (D) **NATIVE AMERICAN & ALASKAN HEALTH** Agriculture Production (LaSells Stewart)
Moderator/Discussant: Turner Goins
1. **Coordinated Care Organizations: Implications for Oregon Tribes**
Turner Goins, Lydia Riley
 2. **An Update on Maternal and Infant Health Among Oregon’s American Indian and Alaska Native Population: Maternal Characteristics and Birth Outcomes from Linkage to 2008-2010 Birth Certificates**
Suzanne Zane, Megan Hoopes, Meena Patil, Jenine Dankovchik, Victoria Warren-Mears
 3. **Motor Vehicle Crash Mortality Among Northwest American Indians and Alaska Natives**
Megan Hoopes, Jenine Dankovchik, Luella Azule, Bridget Canniff, Erik Kakuska, Victoria Warren-Mears
- (E) **PUBLIC HEALTH POLICY** Agriculture Leaders (LaSells Stewart)
Moderator/Discussant: Tom Eversole
1. **How Public Health and Policy Makers Can Collaborate to Promote Policy Change**
Facilitator: Katie Riley
Lesli Uebel, Judy Sundquist, Linda Modrell, Tatiana Dierwechter, Jean Cowan
 2. **Stories from Capitol Hill**
Craig Mosbaek
- (F) **TRENDS IN HEALTH DATA ANALYSIS** Agriculture Science (LaSells Stewart)
Moderator/Discussant: Brian K. Johnson
1. **Collaborative Efforts in Health Care Workforce Data Collection**
Mary Rita Hurley, Kelley Ilic
 2. **How Do We Know When “It Gets Better”?: Monitoring the health of LGBTQ youth in Oregon**
Kari Greene

3. Improving the Accuracy of BRFSS Estimates in the 21st Century
Kathy Pickle, Stacey Schubert

(G) OEHA: Room 111 (Alumni Center)

Integrated Pest Management - Improving Children's Health Through "IPM"?
Tim Stock

12:00 - 1:15 Luncheon and Networking Cascade Ballroom 110C (Alumni Center)

(A) Chiropractic Section Meeting Weyerhaeuser (LaSells Stewart)

(B) Disabilities Section Meeting Agriculture Production (LaSells Stewart)

(C) Epidemiology and Biostatistics Section Meeting Agriculture Leaders (LaSells Stewart)

(D) Health Education and Promotion Section Meeting Agriculture Science (LaSells Stewart)

(E) Nursing Section Meeting Cascade Ballroom 110B (Alumni Center)

(F) Adolescent Health Section Meeting Room 115 (Alumni Center)

(G) Medical Providers for the Underserved Section Meeting Wells Fargo (LaSells Stewart)

(H) Healthy Environment Section Meeting Construction/Eng. Aud. (LaSells Stewart)

OEHA Lunch & Networking Opportunities Room 111 (Alumni Center)

1:15 - 2:30 Concurrent Sessions #2

(A) PANEL: Agriculture Production (LaSells Stewart)

Health Data Analytics

Moderator/Discussant: Ian Schurr
Ian Schurr, Jay Schindler, Ellen Larsen

(B) PANEL: Room 115 (Alumni Center)

Integrating Public Health and Primary Care: Experience and Perspectives of OSU Public Health Students and Graduates

Moderator/Discussant: Jana Kay Slater
Andres Cardenas, Anna Hsu-Rincon, Emily McNulty, Julia Young-Lorion

- (C) **CLIMATE CHANGE AND GREEN SOLUTIONS** Construction/Eng. Aud. (LaSells Stewart)
Moderator/Discussant: Dianna Pickett
1. **Climate Change Health Risk Assessment Model**
Brian E. Cooke, Meghan Dalton
 2. **Oregon's Climate and Health Problem: Progress and Lessons Learned**
Jae Douglas, Mandy Green, Andrea Hamberg
 3. **Strategic Health Impact Assessment on Wind Energy Development in Oregon**
Jae Douglas, Sujata Joshi
- (D) **LATINO HEALTH** Agriculture Science (LaSells Stewart)
Moderator/Discussant: Jeff Bethel
1. **Escuchando a Nuestros Jovenes: A Latino Youth Photovoice Project on Teen Pregnancy**
Joanne Noone, Maggie Sullivan, Glenise McKenzie, Tiffany Allen, Teresa Esqueda, Nancy Ibarra
 2. **Occupational Stress in Latino Agricultural Workers**
Meagan Shaw, Silvia Huszar, Diane S. Rohlman
 3. **Reproductive and Sexual Health Care for Latino Men in Rural Oregon: Providers' Experiences and Perceptions**
Megan Cahn, S. Marie Harvey, Meredith R. Branch, Antonio Torres
- (E) **ISSUES IN HEALTH CARE ACCESS** Cascade Ballroom 110B (Alumni Center)
Moderator/Discussant: Amanda Lawrence
1. **Health is a Business for Everyone and Is Not a Right to Anyone: Neoliberal Health Care in Rural Guatemala**
Clarice Amorim
 2. **Oregon's Health Care Interpreters and Health Systems Transformation**
Carol Cheney, David Cardona
 3. **Prenatal Care and the Oregon Health Plan: Access Denied?**
Angie Docherty, Alison Johnston
- (F) **REPRODUCTIVE AND SEXUAL HEALTH** Agriculture Leaders (LaSells Stewart)
Moderator/Discussant: Jocelyn Warren
1. **Chlamydia Trachomatis: Retesting Practices and repeat infection, Infertility Prevention Project-Oregon, January-June 2010**
Genevieve L. Buser, Sean Schafer, Katrina Hedberg

2. **One Key Question: Integrating Pregnancy Intention Screening into WIC and Home Visit Programs for Postpartum Women**
Anne Morrill, Julie Reeder, Michele Stranger Hunter, Helen Bellanca
3. **Oregon Public Health Division Working to Support Youth Sexual Health**
Stefanie Murray, Lindsay Weaver

(G) **OEHA:** Room 111 (Alumni Center)

Decision to Grant a Cryptosporidium Treatment Variance for Portland's Bull Run Source
Kari Salis

2:30 - 2:45 **BREAK** Gallery/Lobby (LaSells Stewart)

2:45 - 4:00 **Concurrent Sessions #3**

(A) **PANEL:** Construction/Eng. Aud. (LaSells Stewart)

Using Local Data Locally: Public Health Epidemiology in Action at Local Health Departments in Oregon

Moderator/Discussant: James A. Gaudino
Kimberly Repp, Sunny Lee, Sandra Goeke, Sarah Kingston, Ashley Borin

(B) **ACADEMIC & COMMUNITY PARTNERSHIPS** Agriculture Leaders (LaSells Stewart)
Moderator/Discussant: Sheryl Thorburn

1. **Integrated Curriculum for Students of Public Health and Urban Planning**
Stephanie Farquhar, Vivek Shandas
2. **Innovative Inter-Professional Population Health Classroom Strategy: Neighborhood Based Partnership with North Portland Community Health Workers**
Barb Braband, Jason Skipton, Eca-Etabo D. Wasongolo
3. **Student Service Learning Impact on Health: An Academic/Community Collaborative Partnership to Improve Health Outcomes**
Heather Voss, Launa Rae Mathews

(C) **FLUORIDATION & PUBLIC HEALTH** Cascade Ballroom 110B (Alumni Center)
Moderator/Discussant: Viktor Bovbjerg

1. **An Oregon Case Study: Lessons Learned from a Public Health Political Campaign to Bring Water Fluoridation to 1 Million Residents**
Raquel Bournhonesque, Mel Rader

2. **Water Fluoridation Prevents Operations for Severe Cavities in Children**
Kurt Ferre

3. **Community Water Fluoridation: 67 Years of Safe Practice**
Charles C. Haynie

(D) **TOBACCO**

Agriculture Science (LaSells Stewart)

Moderator/Discussant: JoAnne Bunnage

1. **Assessment of Stores for Tobacco and Healthy Foods**
Craig Mosbaek, Scott France

2. **Designing and Using Political Feasibility Assessments: Tobacco-Free Downtown Areas in Deschutes County Case Study**
Ashley Evenson, David Visiko

3. **Life Course Impact of Neighborhood Disparities: The Role of Tobacco**
Sam Hermes, Kenneth Rosenberg, Janne Boone-Heinonen

(E) **WORKPLACE & COMMUNITY WELLNESS**

Agriculture Production (LaSells Stewart)

Moderator/Discussant: Bo Zhang

1. **Coast to the Cascade Community Wellness Network—Coordinated Approach to Child Health CATCH Program**
JoAnn Miller

2. **Wellness @ Work**
Dawn Robbins, Rebecca Pawlak

(F) **OEHA:**

Room 111 (Alumni Center)

Zoonoses, Cryptococcus gaatii
Dr. Emilio DeBess

OPHA Board of Directors Meeting

Wells Fargo (LaSells Stewart)

4:00 - 5:00 **OEHA Annual General Meeting**

Room #111 (Alumni Center)

4:00 - 6:00 **BREAK/NETWORKING & Hors d'Oeuvres**

Alumni Center Foyer and Hallway

4:00 - 6:00 **Conference Poster Session**

Alumni Center Foyer and Hallway

5:30 - 6:30 **Health Care for All Oregon:**
Discussion with Dr. Sam Metz of HCAO

Wells Fargo (LaSells Stewart)

5:30 - 7:00 **Public Health Book Group:**
The Spirit Catches You and You Fall Down
by Anne Fadiman
Discussion Led by Koneng Lor and Facilitated by Lisa Voltolina, and hosted by the OPHA Disability Section

Weyerhaeuser Room (LaSells Stewart)

End of Day One

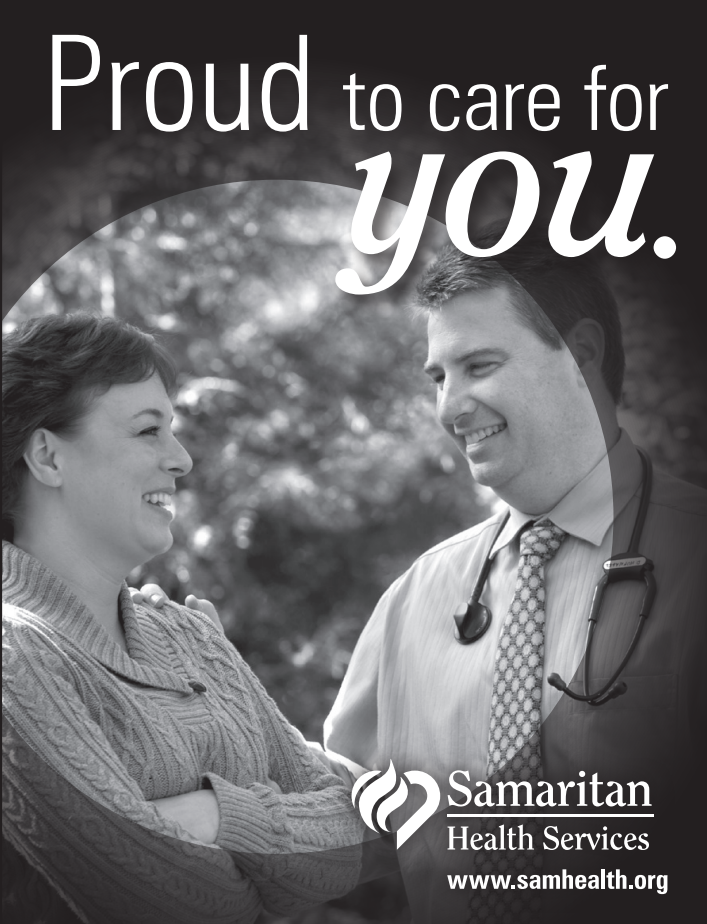

Proud to care for
you.



Samaritan
Health Services
www.samhealth.org

Need a physician? Call today: 1-800-863-5241.

REDE
GROUP
.....
STRATEGY | **HEALTH** | POLICY
.....

COMMUNITY HEALTH ASSESSMENTS
COMMUNITY HEALTH IMPROVEMENT PLANS
PUBLIC HEALTH ACCREDITATION
POLICY ANALYSIS & STRATEGY
STRATEGIC PLANNING
WORKSHOPS & TRAINING
.....

Working with communities to change
the context for a healthier future



www.RedeGroup.co
503.764.9696 • PORTLAND, OREGON

CHANGE TAKES CHANGE.
That's the only way it's going to happen.
BY CREATING HEALTHIER
COMMUNITIES
We're making HEALTH CARE
MORE AFFORDABLE.
Yeah, we're changing the SYSTEM.



Moving Health Forward
Individual / Group / Medicare

Impassioned civil
discourse in your
pajamas.

Opt in for our
region's future.

Opt In lets you take online surveys about
decisions that will affect our region's future.

Sign up now by visiting optinpanel.org.
It's fast, easy and anonymous.



optin
ONLINE PANEL

Come join the world of public health.

Since 1994, Portland State University, Oregon
Health & Science University, and Oregon State
University have offered graduate study in the
dynamic and growing field of public health.

Let the Oregon Master of Public Health program
set you on an exciting path to one of the world's
fast growing and most rewarding careers.

Make an investment in your community, your
world and you.

Visit oregonmph.org
or call **503-725-5186**.



Inform. Educate. Connect.

Go online to salemhealth.org/chec or
call 503-814-2432 for more information





OPHA 68th Annual Meeting and Conference 2012 Agenda

TUESDAY, OCTOBER 9, 2012

- 8:00 - 8:30 **Registration and Continental Breakfast** Gallery/Lobby (LaSells Stewart)
- 8:30 - 9:00 **Welcome and Introductory Comments** Austin Auditorium (LaSells Stewart)
Tom Eversole, DVM, MS
President-elect- Oregon Public Health Association
- 9:00 - 10:00 **Keynote Address:** Austin Auditorium (LaSells Stewart)
Putting Health back into Health Reform
Bruce Goldberg, MD
Director - Oregon Health Authority

Introduction:
Tom Eversole, DVM, MS
- 10:00 - 10:30 **Brief Reports from OPHA Sections** Austin Auditorium (LaSells Stewart)
Introductions: Tom Eversole, DVM, MS
- 10:30 - 10:45 **BREAK** Gallery/Lobby (LaSells Stewart)
- 10:30 - 2:00 **Special Supplemental Nutrition Program for Women,
Infants and Children (WIC) Poster Session** Alumni Center Hallway
- 10:45 - 12:00 **Concurrent Sessions #4**
- (A) **PANEL:** Construction/Eng. Aud. (LaSells Stewart)

 Public Health Accreditation: Oregon's Vision and Progress
 Moderator/Discussant: Craig Mosbaek
 Jill Thompson, Lydia Emer, Erin Mowlds
- (B) **PANEL:** Agriculture Production (LaSells Stewart)

 Critical Indicators for Adolescent Health: Prevention Efforts in Oregon
 Moderator/Discussant: Robert Nystrom
 Isabelle Barbour, LaShanda Eller, Elizabeth Thorne

- (C) **ACCESS TO HEALTHY OPTIONS** Wells Fargo (LaSells Stewart)
Moderator/Discussant: Chunhuei CHI
1. **An Integrative Approach to Tribal Policies in Northwest Tribes**
Kerri Lopez
 2. **Creating a Healthier Food Environment for Incarcerated Women**
Linda Drach
 3. **Rural Yamhill County: The Prospect of Access to Fruits and Vegetables**
Jennifer Johnson
- (D) **EPIDEMIOLOGY AND ENVIRONMENTAL HEALTH** Agriculture Science (LaSells Stewart)
Moderator/Discussant: Molly Kile
1. **A Point-Source Norovirus Outbreak Caused by Exposure to Fomites**
Kimberly Repp, William Keene
 2. **A Regional Strategy to Address Bedbugs: A Diverse Partnership Model for Addressing Emerging Public Health Issues**
Ben Duncan
 3. **The Occurrence of Arsenic in Drinking Water in Transient Non-Community and State-Regulated Water Systems in Oregon**
Cinda Flynn, Molly Kile, Karen Kelley
- (E) **ISSUES IN HEALTH CARE AND ACCESS** Room 115 (Alumni Center)
Moderator/Discussant: Kathleen Carlson
1. **Health Care Providers' Attention to Food Insecurity in Households with Children**
Anne Hoisington, Marc Braverman, Dana Hargunani, Elizabeth Adams, Cheryl Alto
 2. **Improving Access to Medical Homes: Transitioning Public Health Clinic Services to a Federally Qualified Healthcare Clinic**
Marni Storey
 3. **Integrating Public Health Concepts into Medical Care: A Partnership to Implement the Patient Centered Primary Care Home**
Mindy Stadtlander, Safina Koreishi, David Labby
- (F) **EXAMINING PUBLIC HEALTH ISSUES FROM A LIFE COURSE APPROACH** Agriculture Leaders (LaSells Stewart)
Moderator/Discussant: Michelle Odden
1. **Life Course Impact of Neighborhood Disparities: Does Tobacco Retailer Availability Impact Tobacco Use?**
Janne Boone-Heinonen, Rebecca Rdesinski, Sam Hermes, Ashley Howell, Kenneth Rosenberg

2. **Life Course Impact of Neighborhood Disparities: Inequitable Allocation of Resources**
Janne Boone-Heinonen, Ashley V Howell, Kenneth Rosenberg
3. **Life Course Impact of Neighborhood Disparities: The Role of Obesity**
Rebecca Rdesinski, Kenneth Rosenberg, Janne Boone-Heinonen

(G) OEHA

Room 111 (Alumni Center)

Primitive Infrastructure and Environmental Health Interventions

Ron Baker

12:00 - 1:30 OPHA Business Meeting & Awards Luncheon

Cascade Ballroom (Alumni Center)

OEHA Fundraising Luncheon

Scholarship Fund &

Public Health International Fundraising Auction

Room 111 (Alumni Center)

1:30 - 1:45 BREAK

Gallery/Lobby (LaSells Stewart)

1:45 - 3:00 Concurrent Sessions #5

(A) **ACCREDITATION, QUALITY IMPROVEMENT & PERFORMANCE MANAGEMENT ROUND TABLE**

Moderator/Discussant: Erin Mowlds & Ann Brown

Agriculture Production (LaSells Stewart)

(B) PANEL:

Room 115 (Alumni Center)

CHES: WHY I HAVE THESE LETTERS AFTER MY NAME AND WHY YOU SHOULD TOO

Moderator/Discussant: Alissa Leavitt

Gwyn Ashcom, Alissa Leavitt, Laura Chisholm, Julie A. Reeder

(C) PANEL:

Agriculture Leaders (LaSells Stewart)

ALZHEIMER'S AS A PUBLIC HEALTH CRISIS

Moderator/Discussant: Jon Bartholomew

Elena Andresen, Jennifer Mead

(D) **CHILD & ADOLESCENT HEALTH**

Moderator/Discussant: Ken Rosenberg

Agriculture Science (LaSells Stewart)

1. **First Tooth: Statewide Expansion of Preventive Oral Health Services to Oregon's Pediatric Providers**

Amy Umphlett, Kristen Becker

2. **Health Risks of Oregon Eighth-Grade Participants in the “Choking Game”:** Results from a Population-Based Survey

Sarah K. Ramowski, Robert J. Nystrom, Kenneth D. Rosenberg, Julie Gilchrist, Nigel R. Chaumeton

3. **Injury Prevention Counseling During Well-Child Visits in the United States: Rates and Determinants**

Kathleen F. Carlson, Aisling G. Fernandez

(E) **PROMOTING HEALTHY FOOD CHOICES**

Construction/Eng. Aud. (LaSells Stewart)

Moderator/Discussant: Jan Wallinder

1. **Farm to School and School Garden Policy: A Health Impact Assessment Case Study**

Upstream Public Health

2. **Soda Strategies: Reducing the Surplus of Empty Calories**

Kassandra Griffin

3. **Healthy Recipe Development for Implementation in School Meals**

Glenda Hyde, Mary Cluskey, Danita Macy

(F) **TRENDS IN EPIDEMIOLOGY**

Cascade Ballroom 110B (Alumni Center)

Moderator/Discussant: Katrina Hedberg

1. **Trends in Tobacco Use, Obesity and Chronic Disease in Oregon**

Bruce Gutelius

2. **Clusters of Severe Illness Related to “Designer Drugs”**

Genevieve Buser

3. **Re-emergence of En-zootic anthrax in Oregon**

Kara Levri

4. **What’s Hot, What’s Not with Communicable diseases in Oregon**

Katrina Hedberg

(G) **OEHA:**

Room 111 (Alumni Center)

Opportunities Using Advanced Environmental Monitoring Instrumentation

D. Michael Brown

3:00 - 3:15 **BREAK**

Gallery/Lobby (LaSells Stewart)

3:15 - 4:30 Concurrent Sessions #6

- (A) **PANEL:** Construction/Eng. Aud. (LaSells Stewart)
- Public Health Nursing - Generation 2013**
Moderator/Discussant: Rebecca Austen
Patrick Luedtke, Kathy Christensen, Leda Garside, Linda Graham
- (B) **PANEL:** Agriculture Production (LaSells Stewart)
- Partnerships for Healthy Weight Practices in Early Childhood Care and Education Settings**
Moderator/Discussant: Dianna Pickett
Heather Morrow-Almeida, Amanda Peden, Robin Stanton, Helen Visarraga, Dee Wetzel
- (C) **PANEL:** Room 115 (Alumni Center)
- From CHIP to CHIRP: Implementation of the Community Research Enhancement and Education Development (CREED) Program**
Moderator/Discussant: Paul McGinnis
Paul McGinnis, Melinda Davis, Julia Young-Lorion, Beth Ann Beamer, Nancy Kirks, Muriel Delavergne-Brown
- (D) **HEALTH PROMOTION/DISEASE PREVENTION** Agriculture Leaders (LaSells Stewart)
Moderator/Discussant: Tom Engle
1. **Coordinated Messaging for Health Promotion and Chronic Disease Prevention**
Rebecca Pawlak
 2. **Taking Your Practice Upstream: A Cross-Agency Collaboration in Rockwood**
Amanda Lawrence, Anna Jimenez
 3. **The Million Hearts Initiative: The Beat Goes On**
Kim La Croix, Rebecca Pawlak, Steven Fiala
- (E) **MATERNAL MENTAL HEALTH** Agriculture Science (LaSells Stewart)
Moderator/Discussant: Jangho Yoon
1. **Improving Maternal Mental Health in Oregon: The Maternal Mental Health Patient and Provider Education Act**
Nurit Fischler, Wendy Davis
 2. **Racial Disparities of Self-Reported Postpartum Depressive Symptoms Among Foreign Born Women in Oregon**
Ashley Borin, James Gaudino, Aakash Jani

3. Self-Reported Perinatal Depression in Oregon: Findings from a Population-Based Survey of Postpartum Women
Kenneth D. Rosenberg, Alfredo P. Sandoval

F) PANEL: Cascade Ballroom 110B (Alumni Center)

Local Public Health and Coordinated Care Organizations Working Together—
Opportunities for Improved Health Outcomes

Moderator/Discussant: Morgan Cowling

Kathleen O’Leary, Belle Shephard, Carrie Broggoitti, Tom Machala

(G) OEHA: Room 111 (Alumni Center)

‘Swimming Pool Regulation Seminar’

John Mason

Conference Conclusion

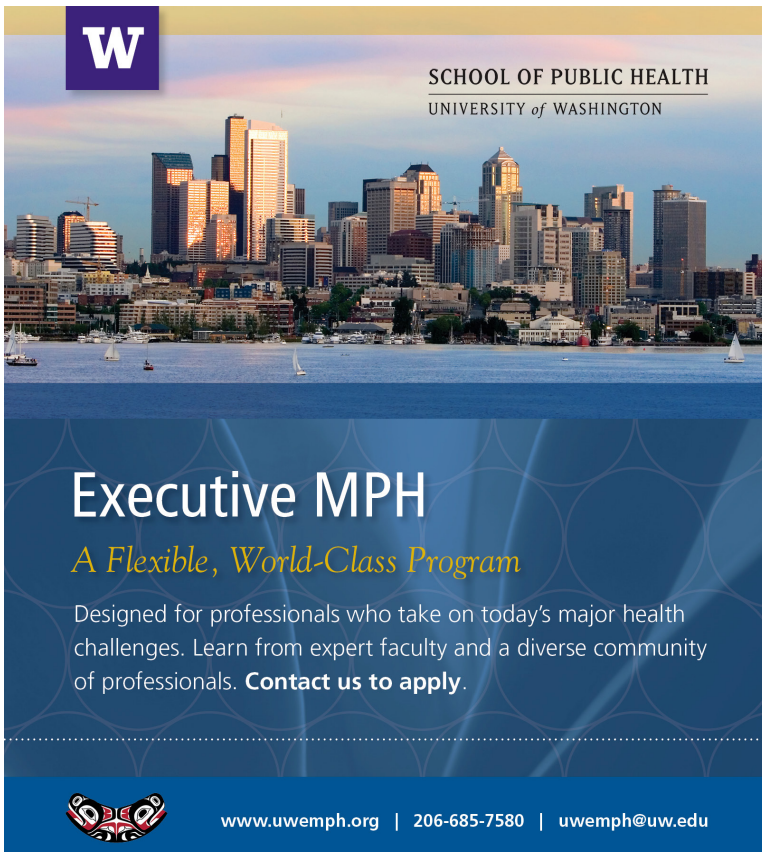

W

SCHOOL OF PUBLIC HEALTH
UNIVERSITY of WASHINGTON

Executive MPH
A Flexible, World-Class Program

Designed for professionals who take on today’s major health challenges. Learn from expert faculty and a diverse community of professionals. **Contact us to apply.**

 www.uwemph.org | 206-685-7580 | uwemph@uw.edu



Health Happens in
Places Where
Oregonians Live,
Work, Learn and Play

Oregon Public Health
Institute (OPHI) is proud to partner
with OPHAtO to improve the health of
communities across Oregon.

oregon
public
health
institute

315 SW Fifth Ave
Suite 202
Portland, OR 97204
503-227-5502
503-416-3696 fax
www.orphi.org

tomorrow's health today

To OSU Campus and Parking Garage

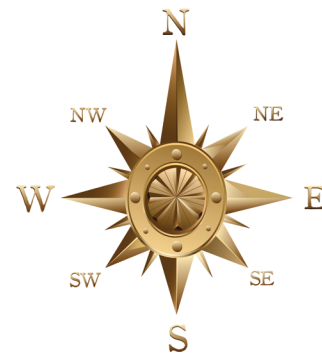
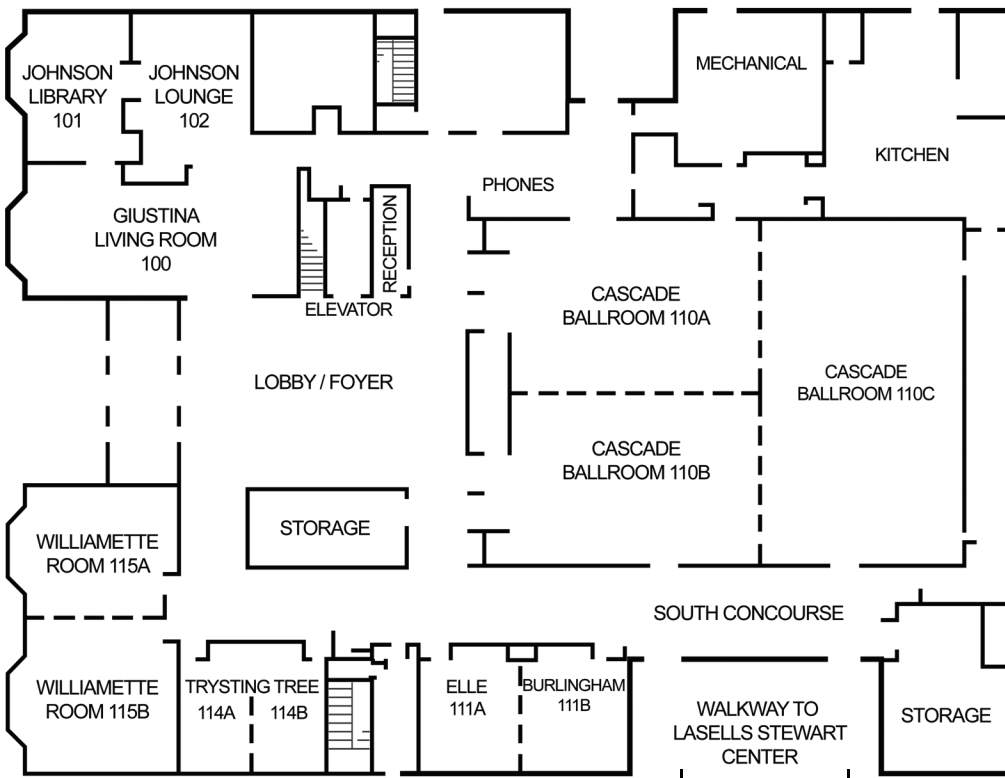

CH2M HILL Alumni Center

26th Street and Reser Stadium Parking Lot

Lawn

Covered Walkway

Patio

LaSells Stewart Center

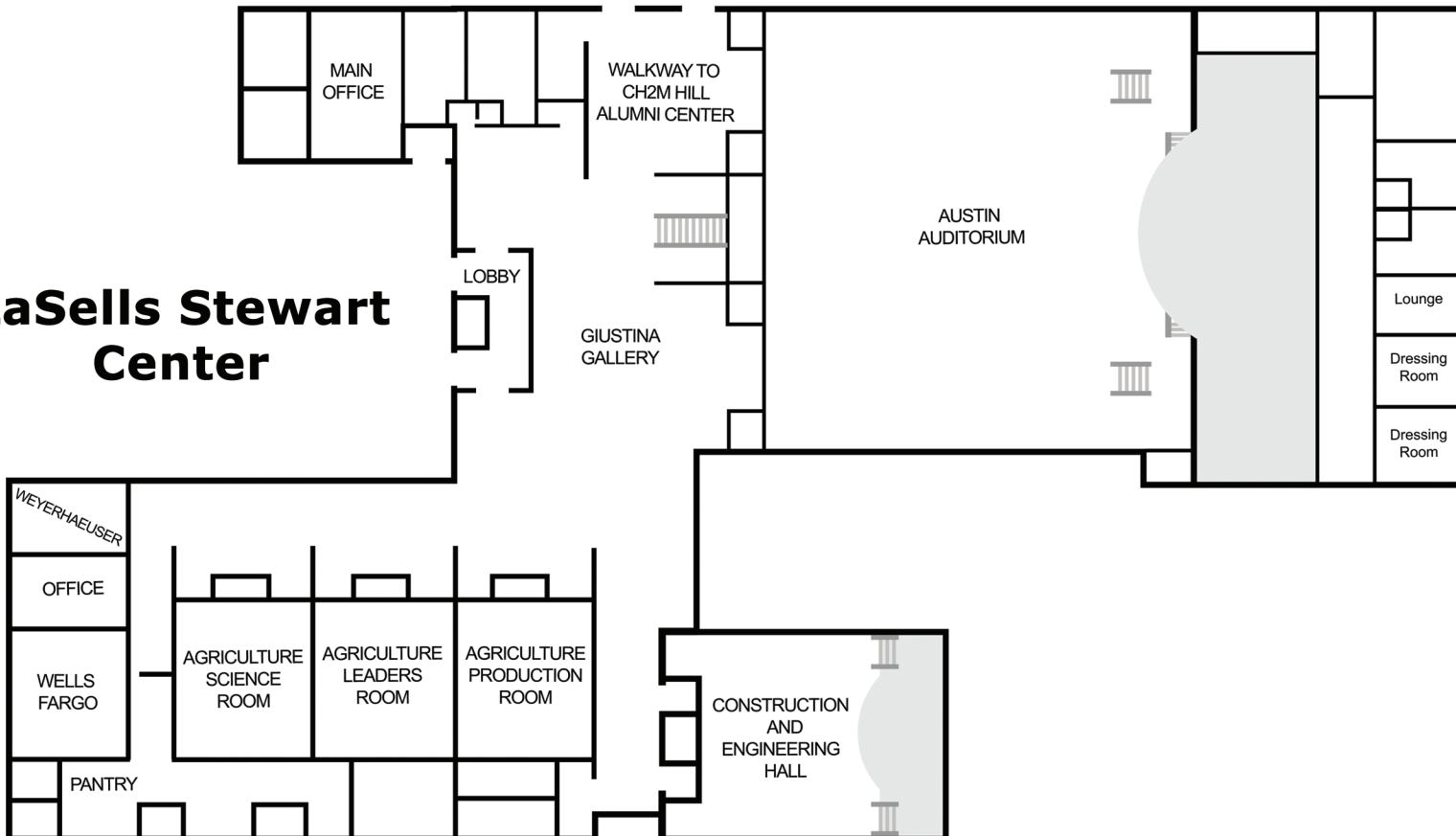

To Hilton Garden Inn and Highway 34

OPHA 2012 is made possible by the generous support of:

Gold Sponsors



NORTHWEST HEALTH
FOUNDATION

The Community's Partner for Better Health



Keynote Sponsor



Community Partner



Bronze Sponsors



Exhibitors



GRAND CANYON
UNIVERSITY™



Rooted in Community, Reaching for Health



"Hands On," by Lucero Salcido, Age 18, Bandon, Oregon

Photo submitted to the 2012 Public Health Youth Photo Contest, a partnership between Northwest Health Foundation and the Oregon Public Health Division. Caption: "I see this photo as a healthier Oregon because it's showing young adults teaching the safety of your brain and head to third graders."

NWHF salutes our youth, our diverse communities, our state and local public health departments, and all the attendees of the 2012 OPHA Conference.

NORTHWEST HEALTH
FOUNDATION

The Community's Partner for Better Health

COLLEGE OF PUBLIC HEALTH AND HUMAN SCIENCES

Graduate public health programs at Oregon State

Join us!

Through rigorous academic programs and a diverse range of research endeavors, graduate students gain the theoretical foundations, applied research techniques and professional skills to function effectively in reducing risks, promoting health and preventing premature disease and disability in human populations.

Choose from a comprehensive range of MPH degree options in six major tracks

- Biostatistics
- Environmental and Occupational Health and Safety
- Epidemiology
- Health Management and Policy
- Health Promotion and Health Behavior
- International Health

In addition to offering the MPH, we are the only institution in Oregon that offers a Ph.D. in public health.

The degree is offered with concentrations in

- Environmental and Occupational Health and Safety
- Health Policy
- Health Promotion and Health Behavior

Learn more by contacting eileen.kaspar@oregonstate.edu or visiting bit.ly/osu-public-health.

New this fall, Oregon State's Ecampus is offering an online graduate certificate in public health.

Credits earned from the six courses in this program may be applied toward an MPH. Find out more at

ecampus.oregonstate.edu/health.

Ensuring lifelong health and well-being for every person, every family, every community

Oregon State
UNIVERSITY